

DEORE XT Front Chainwheel FC-M752

2003

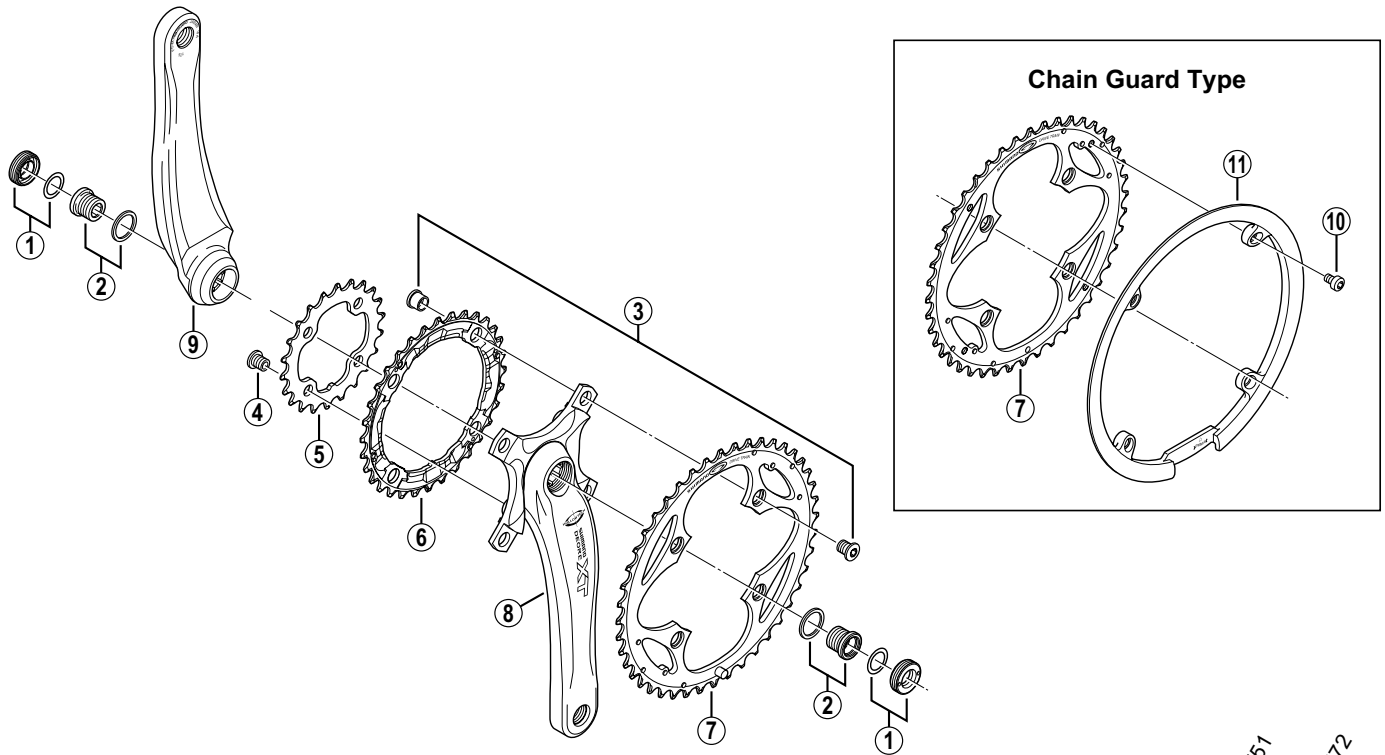

- Chaining teeth combinations: 44 - 32 - 22T / 48 - 36 - 26T
- Bolt circle diameter: 104 mm...(For outer gear and middle gear), 64 mm...(For inner gear)

FC-M751
FC-M572

ITEM NO.	SHIMANO CODE NO.	DESCRIPTION	INTERCHANGEABILITY	
1	Y-1E4 98010	Crank Arm Cap & Plastic Washer		
2	Y-1E4 98020	Crank Arm Fixing Bolt & Washer		
3	Y-1C6 98020	Double Gear Fixing Bolt (M8 x 9.2) & Nut (4 sets)	A	
4	Y-1BD 98030	Inner Gear Fixing Bolt (M8 x 8.5 / 4 pcs.)	A	A
5	Y-1C6 22100	Chainring 22T (Silver)	A	B
	Y-1DS 26000	Chainring 26T (Silver)		
6	Y-1C8 93200	Chainring 32T (Silver)	A	A
	Y-1DS 98200	Chainring 36T (Silver)		
	Y-1C6 98030	Chainring 44T (Black)	A	
7	Y-1C6 94401	Chainring 44T (Black) for Chain Guard	A	B
	Y-1E4 98260	Chainring 48T (Black)		
	Y-1E4 98270	Chainring 48T (Black) for Chain Guard		
8	Y-1E4 98040	Right Hand Crank Arm 165 mm	B	
	Y-1E4 98050	Right Hand Crank Arm 167.5 mm	B	
	Y-1E4 98060	Right Hand Crank Arm 170 mm	B	
	Y-1E4 98280	Right Hand Crank Arm 170 mm for 48T	B	
	Y-1E4 98070	Right Hand Crank Arm 172.5 mm	B	
	Y-1E4 98080	Right Hand Crank Arm 175 mm	B	
	Y-1E4 98290	Right Hand Crank Arm 175 mm for 48T	B	
	Y-1E4 98090	Right Hand Crank Arm 177.5 mm	B	
	Y-1E4 98100	Right Hand Crank Arm 180 mm	B	
9	Y-1E4 98110	Left Hand Crank Arm 165 mm	B	B
	Y-1E4 98120	Left Hand Crank Arm 167.5 mm	B	B
	Y-1E4 98130	Left Hand Crank Arm 170 mm	B	B
	Y-1E4 98140	Left Hand Crank Arm 172.5 mm	B	B
	Y-1E4 98150	Left Hand Crank Arm 175 mm	B	B
	Y-1E4 98160	Left Hand Crank Arm 177.5 mm	B	B
10	Y-1E4 98170	Left Hand Crank Arm 180 mm	B	B
	Y-1E4 98250	Chain Guard Fixing Bolt (4 pcs.)	B	B
	Y-1CY 98020	Chain Guard Fixing Bolt (4 pcs.) for 48T	B	A
11	Y-1C6 18000	Chain Guard	A	A
	Y-1DS 08000	Chain Guard for 48T		

A : Same parts.
B : Parts are usable, but differ in materials, appearance, finish, size, etc.
Absence of mark indicates non-interchangeability.

0209-2186A

Specifications are subject to change without notice.

