

⚠ WARNING

- The 203 mm rotor provides a high level of braking force. Make sure that you have a complete feel for the braking characteristics before using the brakes.
- The 180 mm rotor has a stronger braking force than the 160 mm rotor. Make sure that you have a complete feel for the braking characteristics before using the brakes.

Note

- The 203 mm rotor and the 180 mm rotor have a larger diameter and greater curvature than the 160 mm and 170 mm cross-country rotors. As a result, they may touch the brake pads.

Technical Service Instructions

Installation of the adapter for rotors

■ Tightening torque

- Adapter fixing bolts 6 - 8 N·m {53 - 69 in. lbs.}

- Caliper fixing bolts 6 - 8 N·m {53 - 69 in. lbs.}

Installation method

These Service Instructions contain information on installing the adapter to the front fork and frame. Refer to the Service Instructions for the brakes for details on securing the adapter for the calipers. Use the accessory bolts to secure the adapter.

■ Stopping the adapter and front fork / frame fixing bolts from loosening

Either a cap method or a wire ring method can be used to stop the bolts from turning. Use whichever method is suitable for the front fork and frame.

<Wire ring method>

If bolt ① tries to loosen (turn in the counterclockwise direction), force is applied via the wire to turn bolt ② in the tightening direction (clockwise). However, bolt ② cannot turn any further in the tightening direction. Accordingly, this prevents bolt ① from turning in the loosening direction because it is also connected via the wire. If either one of the bolts tries to loosen, this causes a force to be applied to the other bolt to turn it in the tightening direction. In other words, this system prevents the bolts from loosening.

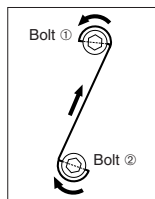
**<Cap method>**

Refer to the diagram at right.

SHIMANO

SHIMANO AMERICAN CORPORATION
One Holland, Irvine, California 92618, U.S.A. Phone: +1-949-951-5003

SHIMANO EUROPE B.V.
Industrieweg 24, 8071 CT Nunspeet, The Netherlands Phone: +31-341-272222

SHIMANO INC.
3-77 Oimatsu-cho, Sakai-ku, Sakai-shi, Osaka 590-8577, Japan

* Service Instructions in further languages are available at :
<http://techdocs.shimano.com>

Please note: specifications are subject to change for improvement without notice. (English)
© Nov. 2009 by Shimano Inc. XBC IZM Printed in Japan.

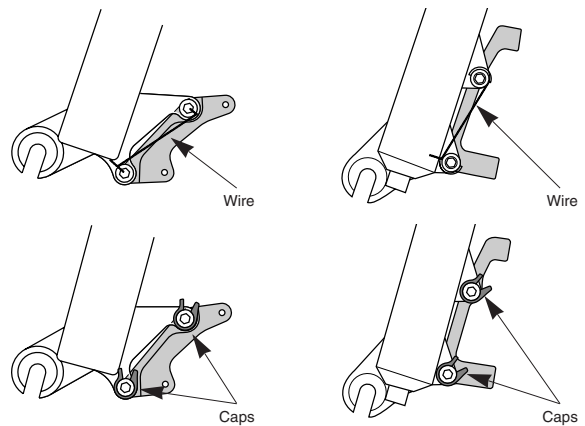
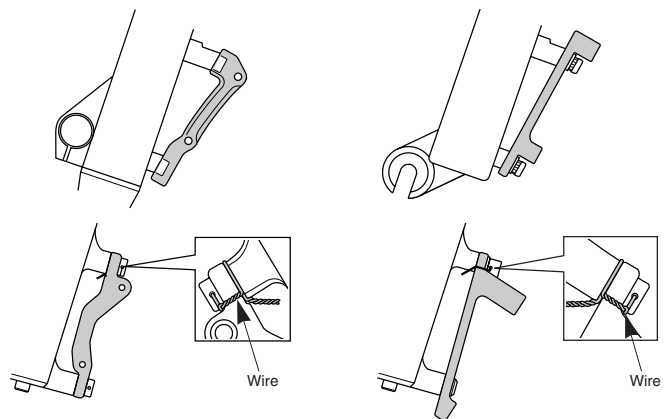
For front**International standard mounting type
(160 / 180 / 203 mm rotors)****Post mounting type
(180 / 203 mm rotors)****For rear****International standard mounting type
(140 / 160 / 180 / 203 mm rotors)**