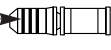
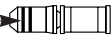

⚠ WARNING

“Maintenance interval depends on the usage and riding circumstances. Clean regularly the chain with an appropriate chaincleaner. Never use alkali based or acid based solvents such as rust cleaners. If those solvent be used chain might break and cause serious injury.”

- In order to obtain good gear shifting performance, this chain has a forward side and a reverse side, and the sides are marked so that the chain will face the correct way when installed. The proper design performance will be obtained when the chain is installed so that it faces the correct way. If it is installed so that it faces the opposite way, the chain may come off and the bicycle may fall over and serious injury may occur as a result.
- Use the reinforced connecting pin only for connecting the narrow type of chain.
- If connecting pins other than reinforced connecting pins are used, or if a reinforced connecting pin or tool which is not suitable for the type of chain is used, sufficient connection force may not be obtained, which could cause the chain to break or fall off.

Chain	Reinforced connecting pin	Chain tool
10-speed super narrow chain for MTB	with groove (3) 	TL-CN32 TL-CN23
	with groove (2) 	TL-CN27

- Make sure that the connecting pin is aligned with the outer link surface from the side that the pin is inserted. It should feel smooth and flush when you run your finger over it. The pin will protrude slightly on the backside after the break off pin is removed.
- If it is necessary to adjust the length of the chain due to a change in the number of sprocket teeth, make the cut at some other place than the place where the chain has been joined using a reinforced connecting pin. The chain will be damaged if it is cut at a place where it has been joined with a reinforced connecting pin.
- When readjusting the length of the chain, be sure to insert the reinforced connecting pin from the same side as the chain cutter was inserted (the same direction as when the chain was cut).
- Check that the tension of the chain is correct and that the chain is not damaged. If the tension is too weak or the chain is damaged, the chain should be replaced. If this is not done, the chain may break and cause serious injury.

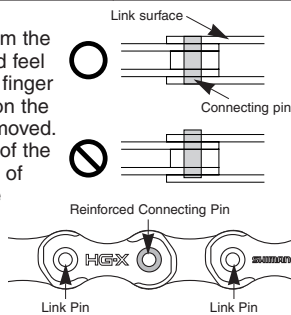

- Obtain and read the service instructions carefully prior to installing the parts. We strongly recommend only using genuine Shimano replacement parts. If adjustments are not carried out correctly, the chain may come off and this may cause you to fall off the bicycle which could result in serious injury.
- Read these Technical Service Instructions carefully, and keep them in a safe place for later reference.

Note

In order to obtain good gear shifting performance, this chain has a forward side and a reverse side, and the sides are marked so that the chain will face the correct way when installed.

Forward
(outer side)

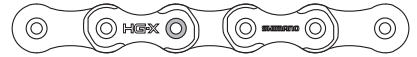

The side with the mark shown in the illustration is the forward side (outer side).

Reverse
(inner side)



As illustrated in Fig. (A), we strongly recommend to set the connecting pin in the hole of the outer link on the front side in the direction of travel.

The chain's level of strength is enhanced compared to the method in Fig. (B).

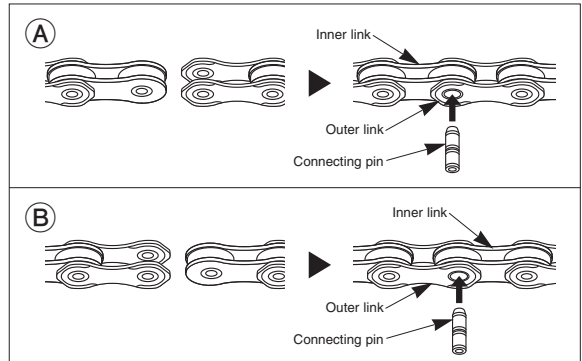
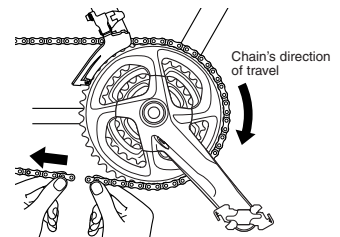

Technical Service Instructions

SI-09L0A-001

CN-M980 / CN-HG94 / CN-HG74**■ Features**

In order to provide greater connecting strength, this reinforced connecting pin has a special shape (the pin is thicker at both ends than at the barrel). A guide for making the pin easier to push into the chain is also provided.

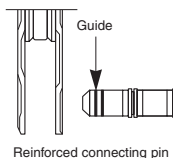
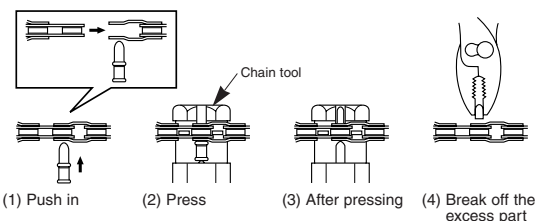
**■ Method of use****SHIMANO**

SHIMANO AMERICAN CORPORATION

One Holland, Irvine, California 92618, U.S.A. Phone: +1-949-951-5003

SHIMANO EUROPE B.V.

Industrieweg 24, 8071 CT Nunspeet, The Netherlands Phone: +31-341-272222

SHIMANO INC.

3-77 Oimatsu-cho, Sakai-ku, Sakai-shi, Osaka 590-8577, Japan

* Service Instructions in further languages are available at : <http://techdocs.shimano.com>

Please note: specifications are subject to change for improvement without notice. (English) © Nov. 2009 by Shimano Inc. XBC SZK Printed in Japan.