

SHIMANO XTR Mega-9 Rapidfire Lever SL-M952

For Left Hand

For Right Hand

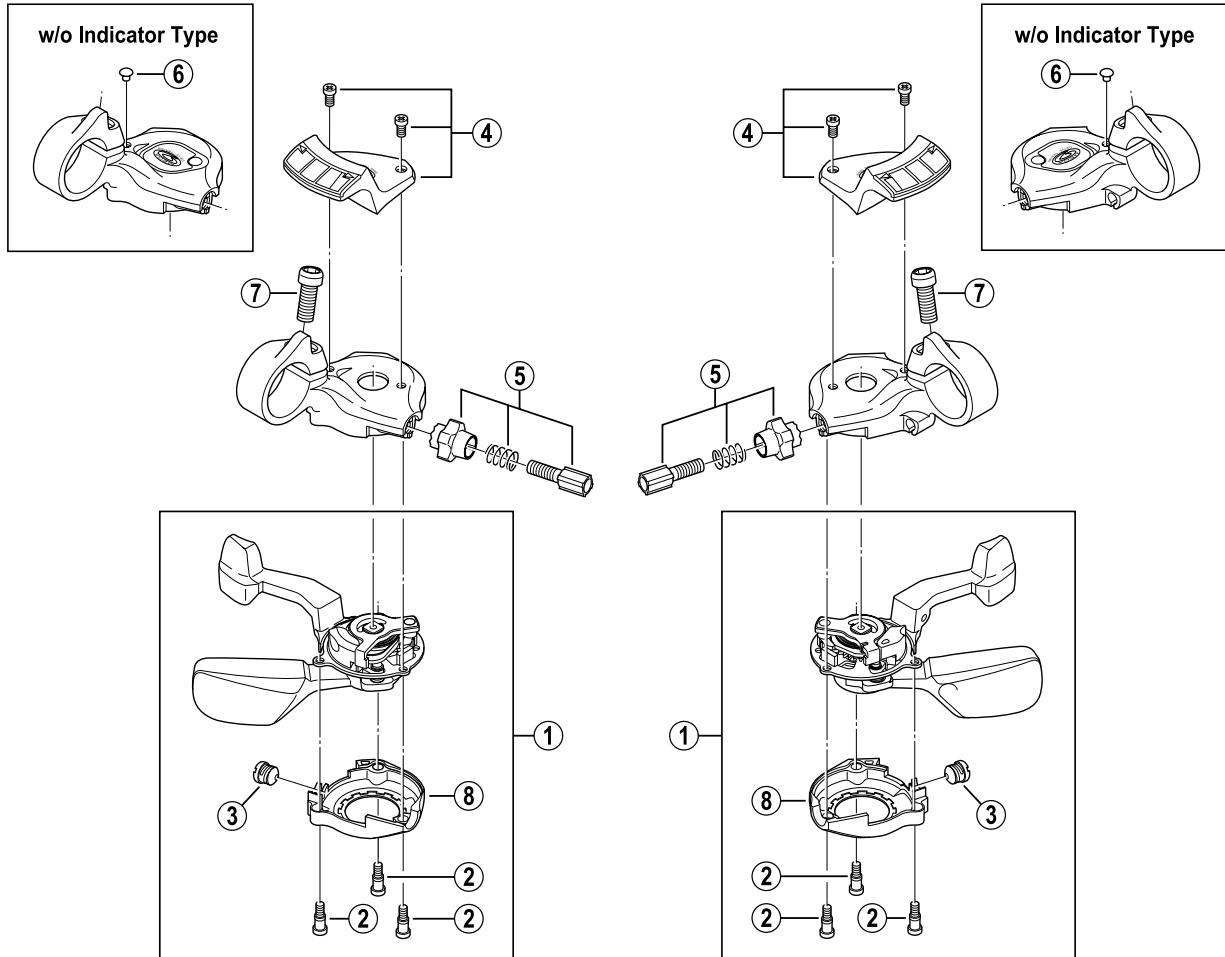

ITEM NO.	SHIMANO CODE NO.	DESCRIPTION
*	1	Y-6CF 98070 R.H. Shifting Lever Unit
	1	Y-6CF 98020 L.H. Shifting Lever Unit
2	Y-6CE 37000	Shifting Lever Unit Fixing Bolt
3	Y-6CD33000	Inner Hole Cap
4	Y-6CF 98030	R.H. Indicator Unit
	Y-6CF 98040	L.H. Indicator Unit
5	Y-6CE 98070	Cable Adjusting Bolt Unit
6	Y-6BV 48000	Base Hole Cap
7	Y-6AS 50110	Clamp Bolt (M6 x 15)
8	Y-6CE 09100	R.H. Unit Cover
	Y-6CE 59100	L.H. Unit Cover

0502-1782C

Specifications are subject to change without notice.

SHIMANO