

General Safety Information

WARNING

– To avoid serious injuries:

- Obtain and read the service instructions carefully prior to installing the parts. Loose, worn or damaged parts may cause the bicycle to fall over and serious injury may occur as a result. We strongly recommend only using genuine Shimano replacement parts.
- Read these Technical Service Instructions carefully, and keep them in a safe place for later reference.

Note

- For smooth operation, use the specified outer casing and bottom bracket cable guide.
- Because the high cable resistance of a frame with internal cable routing would impair the SIS function, this type of frame should not be used.
- The sliding surfaces of the inner cable and outer casing should be greased before use.
- The shifting lever can be installed to handlebars with diameters of 19.0 – 22.0 mm.
- Operation of the levers related to gear shifting should be made only when the front chainwheel is turning.
- Parts are not guaranteed against natural wear or deterioration resulting from normal use.
- For any questions regarding methods of handling or maintenance, please contact the place of purchase.

In order to realize the best performance, we recommend that the following combination be used.

Series	DURA-ACE
Shifting lever	SL-BS79
Rear derailleur	RD-7900
Front derailleur	FD-7900
Outer casing	SP41 sealed outer casing
Inner cable	1.2 mm dia. (stainless steel)
Bottom bracket guide	SM-SP17
Sprockets	10

Installation of the lever

When installing the components to carbon frame/handlebar surfaces, verify with the manufacturer of the carbon frame/parts for their recommendation on tightening torque in order to prevent over tightening that can cause damage to the carbon material and/or under tightening that can cause lack of fixing strength for the components.

The illustration shows an explanation of the case where the shifting lever is installed to drop handlebars. Install the front lever in the same way.

1. Attach the body unit to the handlebar, and then use a 5 mm Allen key to turn the body fixing bolt counterclockwise to tighten it.

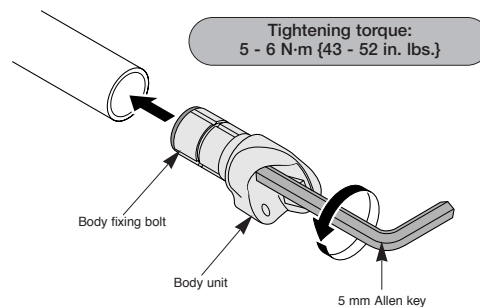

2. Install the lever boss to the body unit.

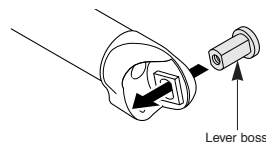

3. Install the lever to the body unit.

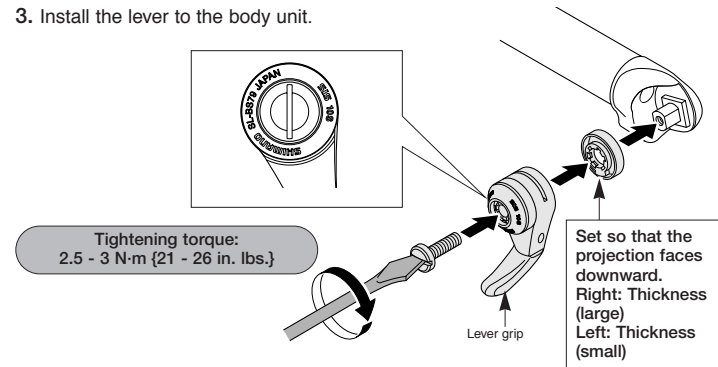

4. Install the outer casing stopper to the brazed-on boss.

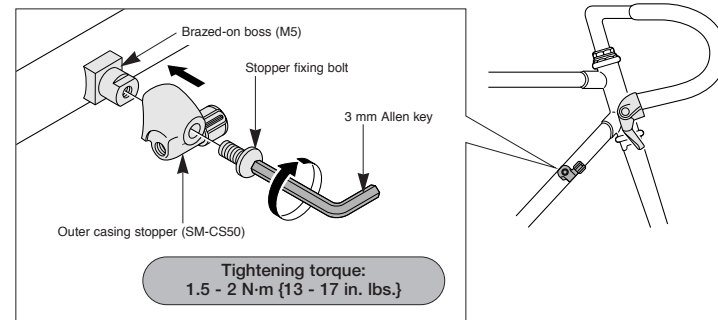

5. With the outer casing placed along the handlebar, cover the outer casing with the outer casing guide, and then use tape or similar material to provisionally attach it to the handlebar.

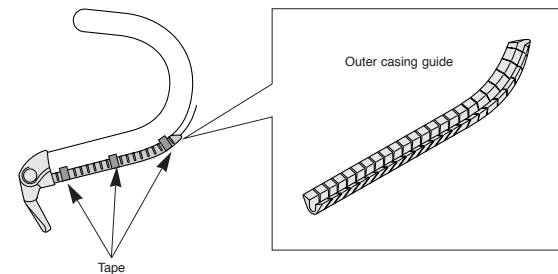

6. Wrap the handlebar with bar tape.

Technical Service Instructions

SI-6RP0A-001

SL-BS79

Bar End Shifting Lever

SHIMANO

SHIMANO AMERICAN CORPORATION
One Holland, Irvine, California 92618, U.S.A. Phone: +1-949-951-5003

SHIMANO EUROPE B.V.
Industrieweg 24, 8071 CT Nunspeet, The Netherlands Phone: +31-341-272222

SHIMANO INC.
3-77 Oimatsu-cho, Sakai-ku, Sakai-shi, Osaka 590-8577, Japan

Please note: specifications are subject to change for improvement without notice. (English)
© May 2008 by Shimano Inc. XBC SZK Printed in Japan.